

FIRST WARD.





Coshocton Corporation

J. M. Brown

H Street

J. Alexander

Bulford

COSHOCTON CORPORATION

ROAD

Tunnel

Cambra Iron & Roofing Co.

William McIlvay

Wilson

Woodworth

STUBENVILLE ST

COMBER

MAIN

WILSONS CREEK

B.O. RR

BARNES

McIlvay

J. A. Cron

Styles

J. E. Wagner

B. Rice

Jacob Goodwin

Winters

Mrs D Broom

Treat Brook

Green

Stoa

910

1112

1314

1516

1718

1920

2122

2324

2526

2728

2930

3132

3334

3536

3738

3940

4142

4344

4546

4748

4950

5152

5354

5556

5758

5960

6162

6364

6566

6768

6970

7172

7374

7576

7778

7980

8182

8384

8586

8788

8990

9192

9394

9596

9798

99100

THIRD WARD

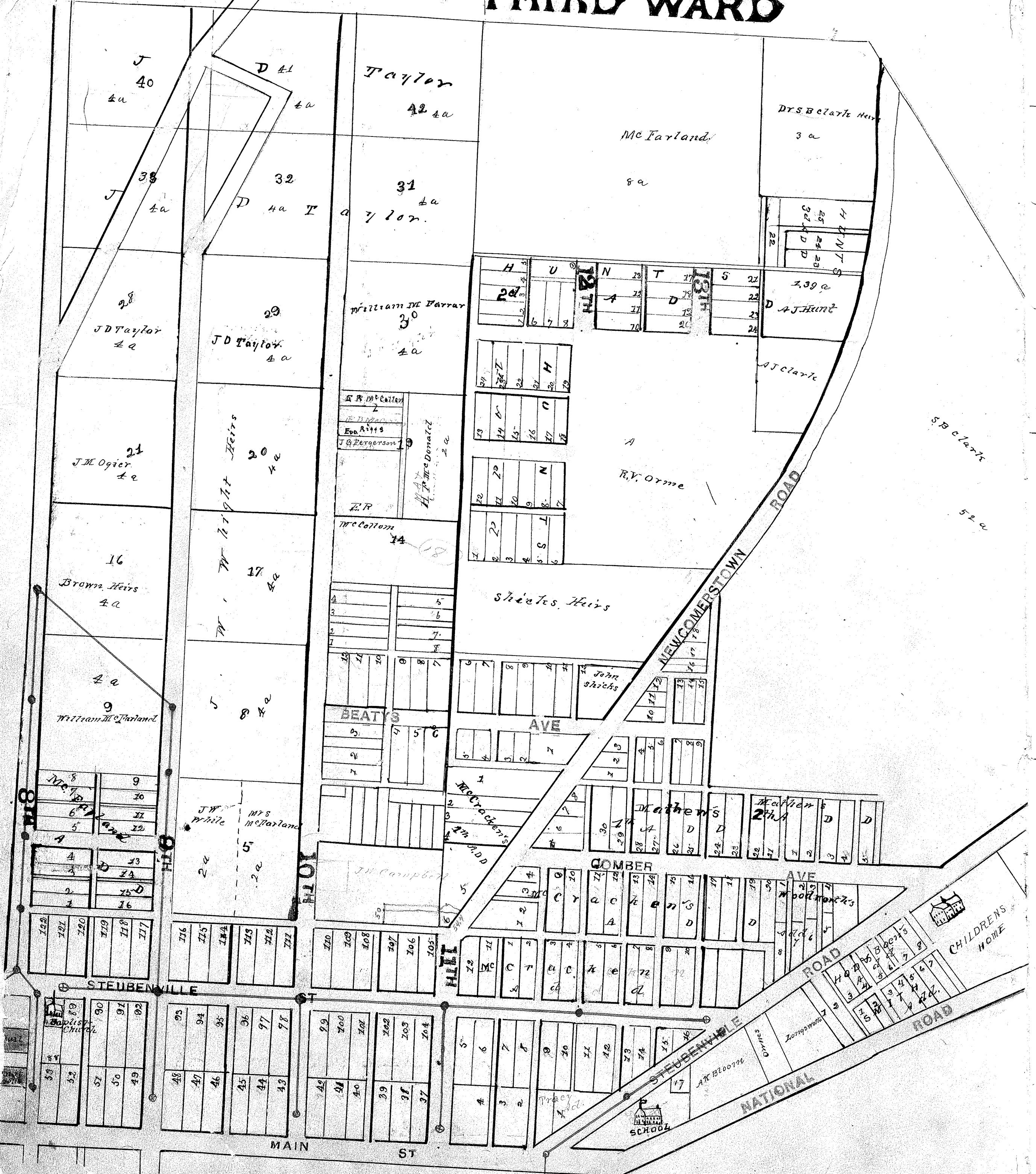

SECOND WARD

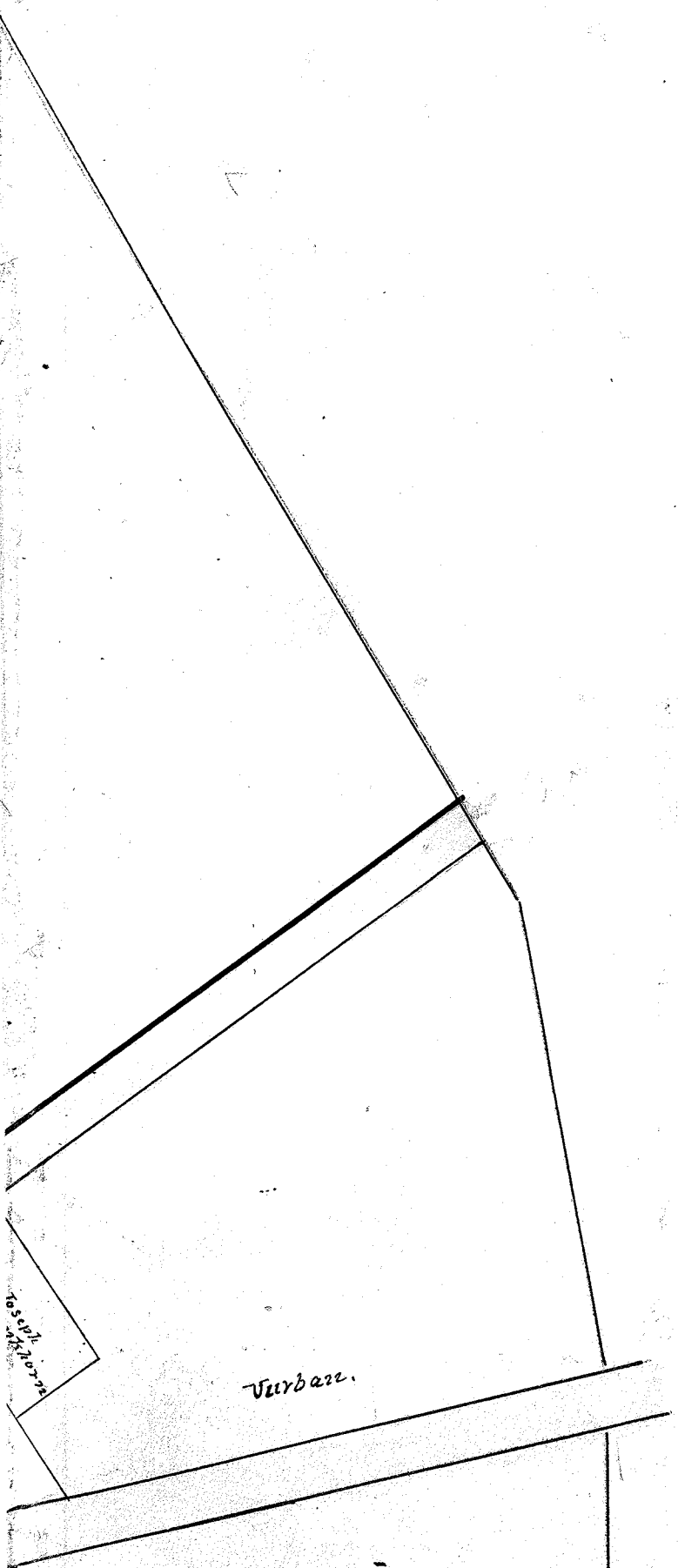

Block	Address	Owner	Notes
1	37	J D Taylor	
2	38	J D Taylor	
3	39	J D Taylor	
4	36	J D Taylor	
5	35	J D Taylor	
6	34	J D Taylor	
7	27	J D Taylor	
8	26	J D Taylor	
9	25	J D Taylor	
10	24	J D Taylor	
11	23	J D Taylor	
12	22	J D Taylor	
13	21	J D Taylor	
14	20	J D Taylor	
15	19	J D Taylor	
16	18	J D Taylor	
17	17	J D Taylor	
18	16	J D Taylor	
19	15	J D Taylor	
20	14	J D Taylor	
21	13	J D Taylor	
22	12	J D Taylor	
23	11	J D Taylor	
24	10	J D Taylor	
25	9	J D Taylor	
26	8	J D Taylor	
27	7	J D Taylor	
28	6	J D Taylor	
29	5	J D Taylor	
30	4	J D Taylor	
31	3	J D Taylor	
32	2	J D Taylor	
33	1	J D Taylor	
34	13	W B Coy	
35	12	W B Arms	
36	11	J G Hyatt	
37	10	Rebecca Brown	
38	9	Lizzie McCutley	
39	8	Peter Dennis	
40	7	Go m b e r	
41	6	SCHOOL	
42	5	CHURCH	
43	4	Jax 7	
44	3	Court House	
45	2		
46	1		

HIGH ST

HIGH ST

HIGH ST

HIGH ST

STUBENVILLE AVE

MAIN ST

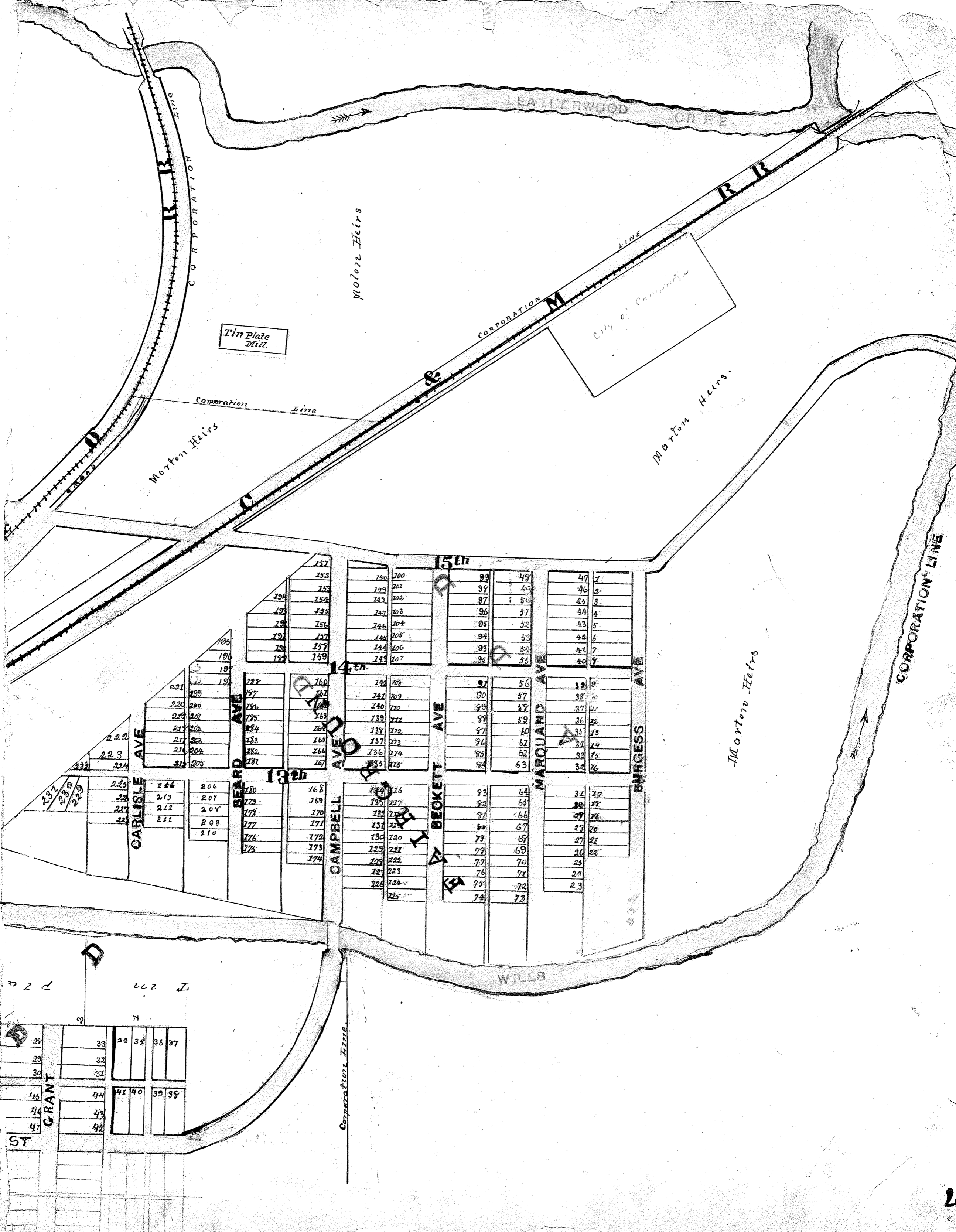

Tin Plate Mill

City of Cambridge

28	33	34	35	36	37
29	32				
30	31				
44	44	41	40	39	38
46	42				
47	42				
ST					

FIRST WARD.

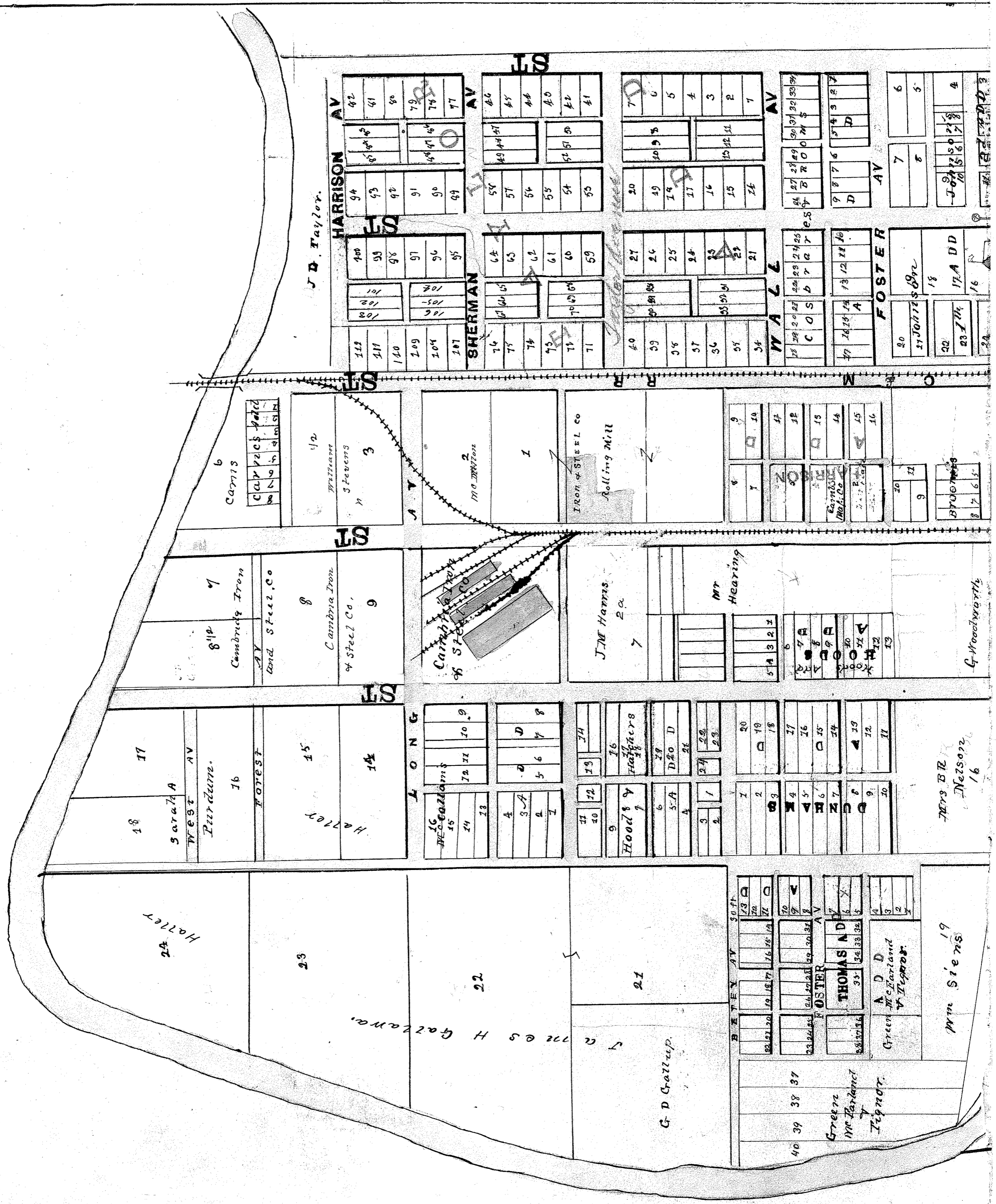

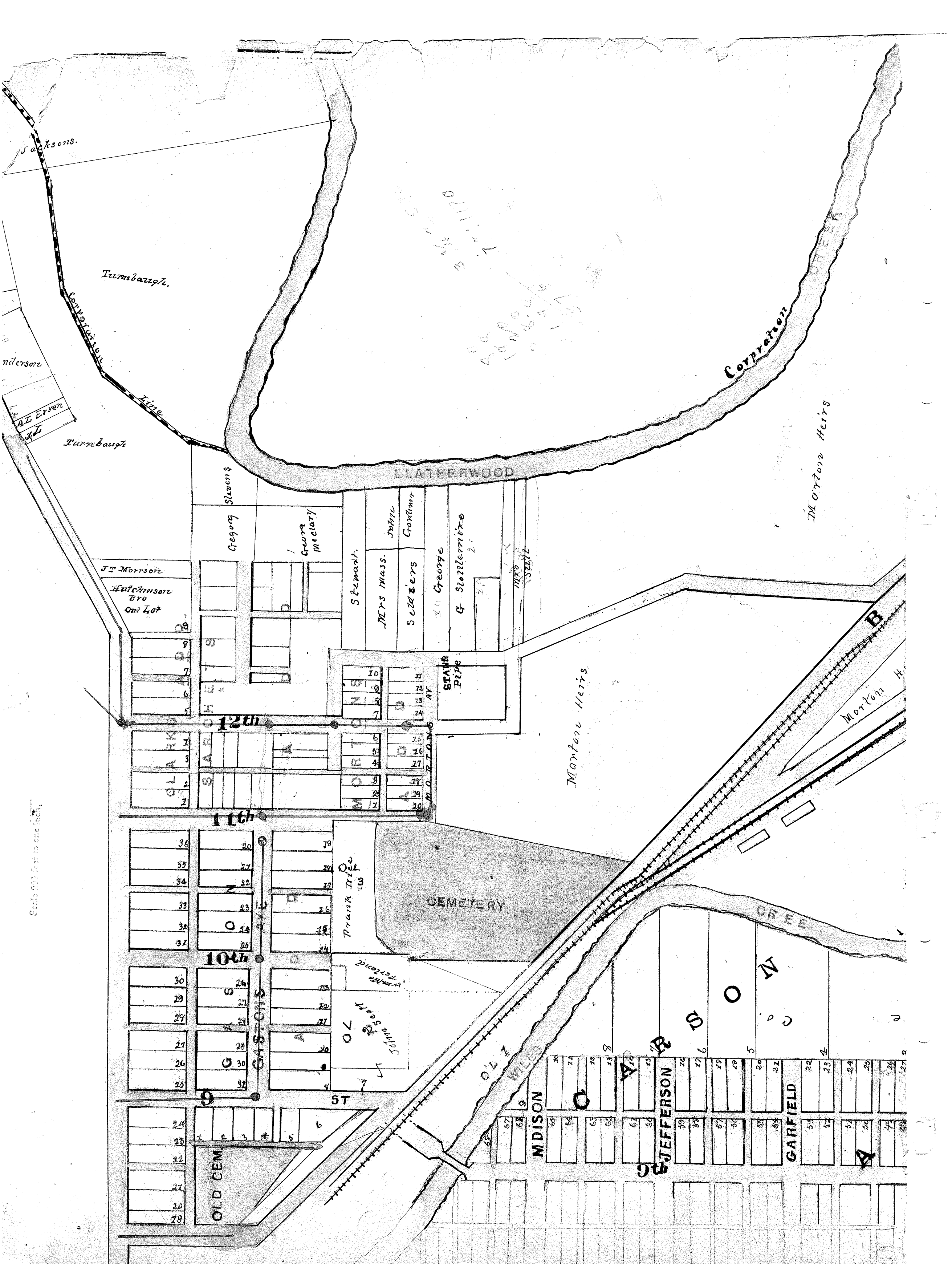

Scale 900 feet to one inch.

Turnbaugh

Sacksons

Hutchinson

Le AZ Erver

Turnbaugh

Hutchinson Bro
Old Lot

Gregory

George Meclary

Stewart

MRS MASS.

Sellers

George

G. Stollemire

STANLEY PIPE

J. T. Morrison

12th

11th

10th

CASTONS AVENUE

CEMETERY

Frank Rice

John Scott

Manlove Heirs

Morrison Heirs

Morrison H.

OLD CEM.

M. DISON

JEFFERSON

GARFIELD

OLD MILL

RAILROAD

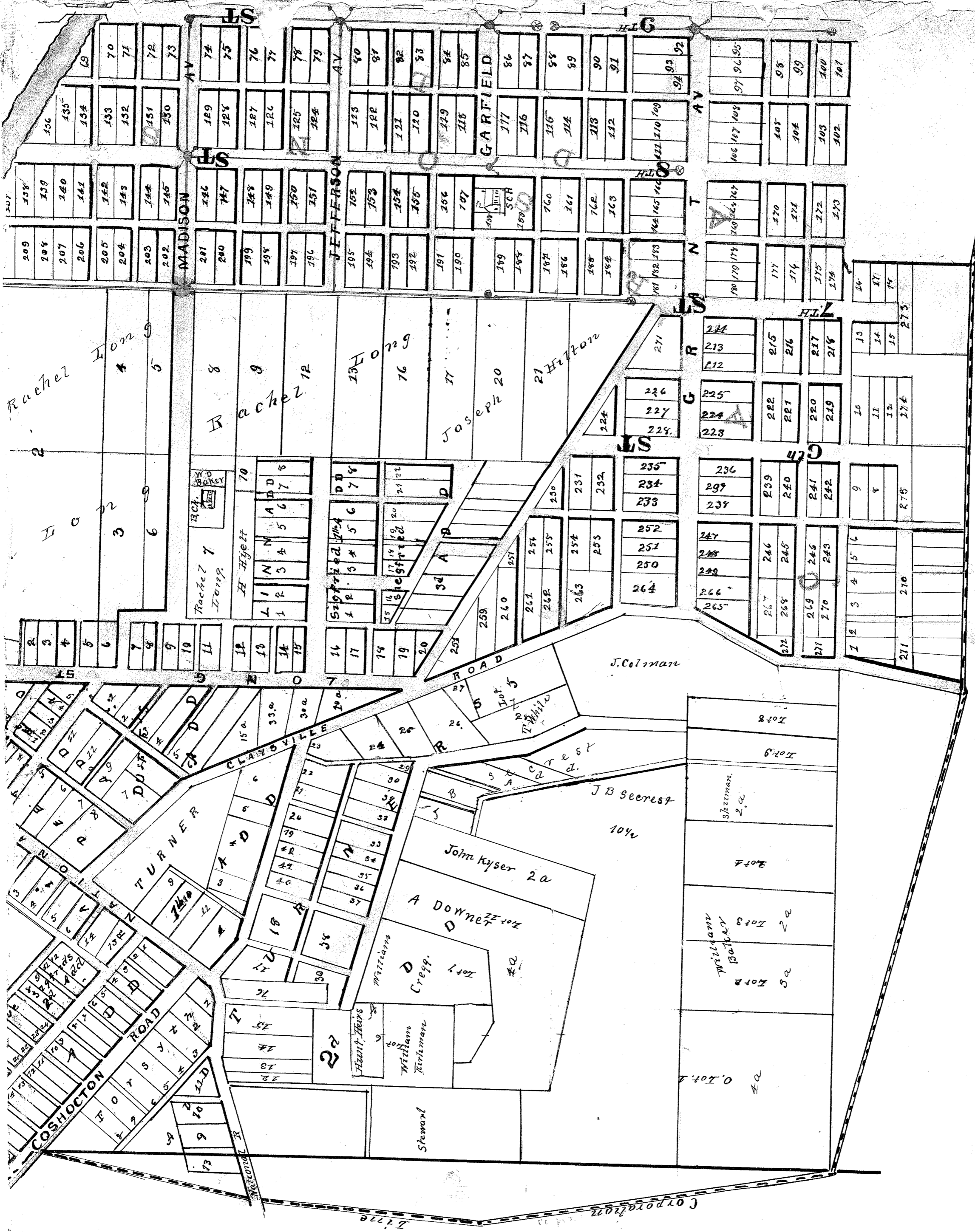

Rachel 1022
4
5
6
7
8
9
10
11
12
13
14
15
16
17
18
19
20
21
22
23
24
25
26
27
28
29
30
31
32
33
34
35
36
37
38
39
40
41
42
43
44
45
46
47
48
49
50
51
52
53
54
55
56
57
58
59
60
61
62
63
64
65
66
67
68
69
70
71
72
73
74
75
76
77
78
79
80
81
82
83
84
85
86
87
88
89
90
91
92
93
94
95
96
97
98
99
100
101
102
103
104
105
106
107
108
109
110
111
112
113
114
115
116
117
118
119
120
121
122
123
124
125
126
127
128
129
130
131
132
133
134
135
136
137
138
139
140
141
142
143
144
145
146
147
148
149
150
151
152
153
154
155
156
157
158
159
160
161
162
163
164
165
166
167
168
169
170
171
172
173
174
175
176
177
178
179
180
181
182
183
184
185
186
187
188
189
190
191
192
193
194
195
196
197
198
199
200
201
202
203
204
205
206
207
208
209
210
211
212
213
214
215
216
217
218
219
220
221
222
223
224
225
226
227
228
229
230
231
232
233
234
235
236
237
238
239
240
241
242
243
244
245
246
247
248
249
250
251
252
253
254
255
256
257
258
259
260
261
262
263
264
265
266
267
268
269
270
271
272
273
274
275
276
277
278
279
280
281
282
283
284
285
286
287
288
289
290
291
292
293
294
295
296
297
298
299
300
301
302
303
304
305
306
307
308
309
310
311
312
313
314
315
316
317
318
319
320
321
322
323
324
325
326
327
328
329
330
331
332
333
334
335
336
337
338
339
340
341
342
343
344
345
346
347
348
349
350
351
352
353
354
355
356
357
358
359
360
361
362
363
364
365
366
367
368
369
370
371
372
373
374
375
376
377
378
379
380
381
382
383
384
385
386
387
388
389
390
391
392
393
394
395
396
397
398
399
400
401
402
403
404
405
406
407
408
409
410
411
412
413
414
415
416
417
418
419
420
421
422
423
424
425
426
427
428
429
430
431
432
433
434
435
436
437
438
439
440
441
442
443
444
445
446
447
448
449
450
451
452
453
454
455
456
457
458
459
460
461
462
463
464
465
466
467
468
469
470
471
472
473
474
475
476
477
478
479
480
481
482
483
484
485
486
487
488
489
490
491
492
493
494
495
496
497
498
499
500

Corporation
1776

FIFTH WARD

Scale 200 feet to one inch.

